

Knowledge of Health and Safety towards Zero Maintenance Machinery Accidents

Check correct usage methods



KOWA SEIKI CO., LTD.
<https://www.kowa-seiki.co.jp/>



Lift

Secure the vehicle with the tie-down belt

Secure both sides
evenly.

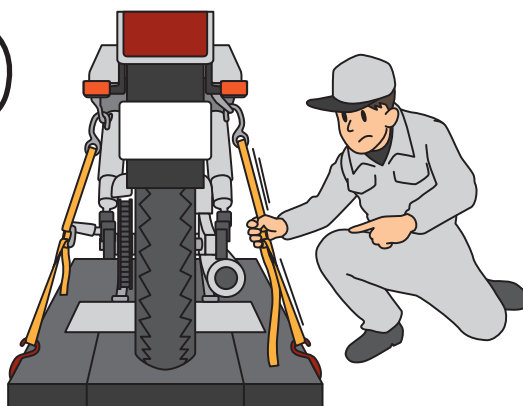

Lift

Check that the safety device lock is on

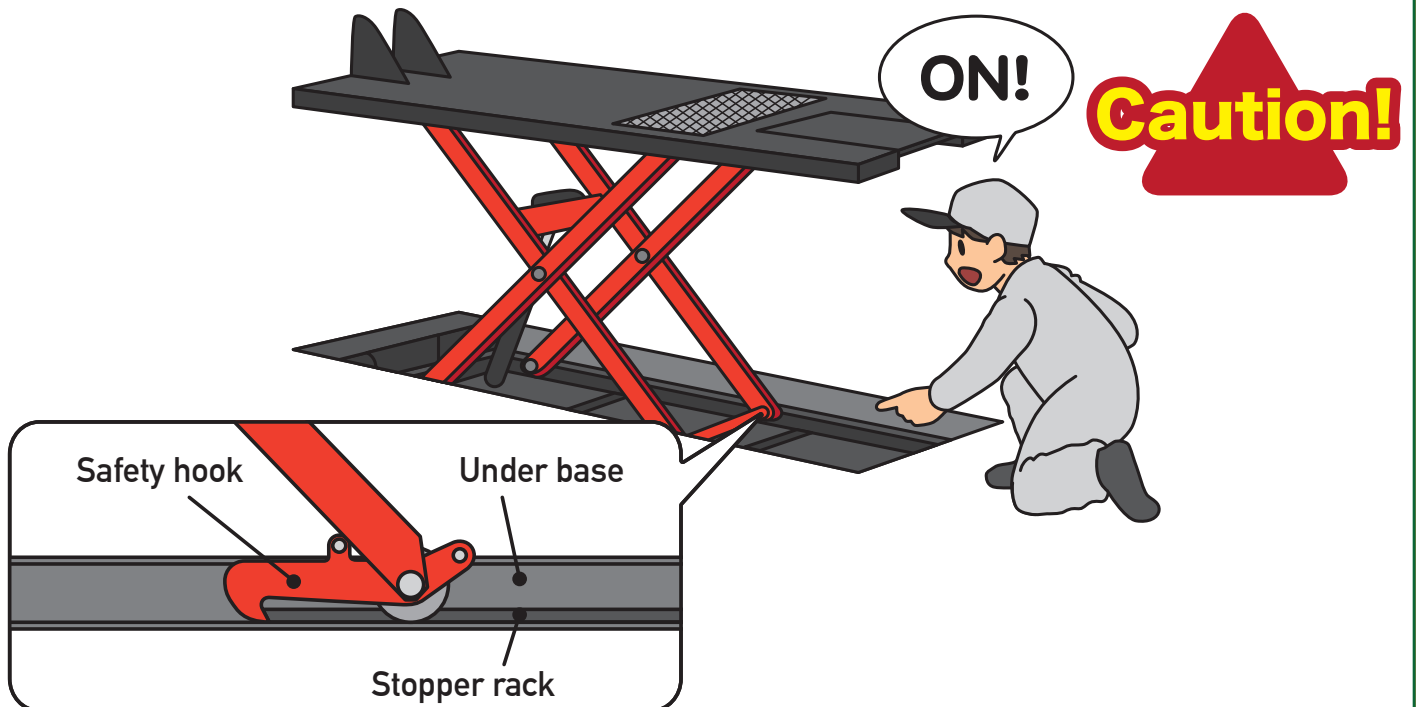

Make sure to check that the safety hook safety click is properly connected to the stopper rack.

Run away if the vehicle looks as though it will fall

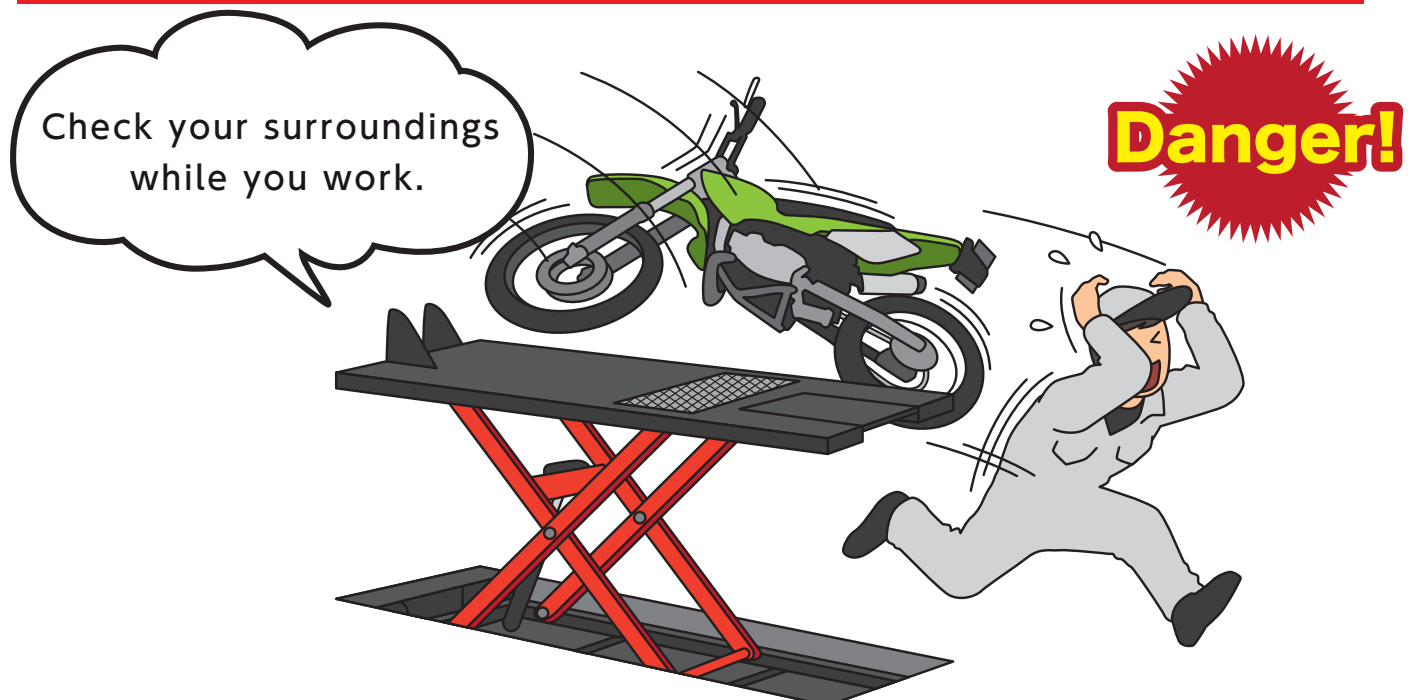

Run! Do not try to hold it up!



Lift

Be careful of weight imbalance



Caution!

Be careful of imbalances due to uneven weight or heavy items detaching.

Do not go under the vehicle

Talk to your work partners and only continue work if they answer.



Don't!

There is a risk of being crushed under the vehicle causing a serious accident.

Do not put your legs or arms under the link part or lift



Caution!

There is a risk of getting stuck causing a serious injury.

Air Compressor

Conduct regular inspections

Check if the safety valve works.

Compressor oil volume and contamination

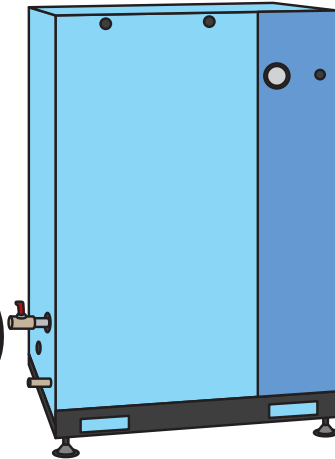

Caution!

Regular water draining

Belt stretching or deterioration

If maintenance is not up to date, this may cause damage to equipment or personal injury.

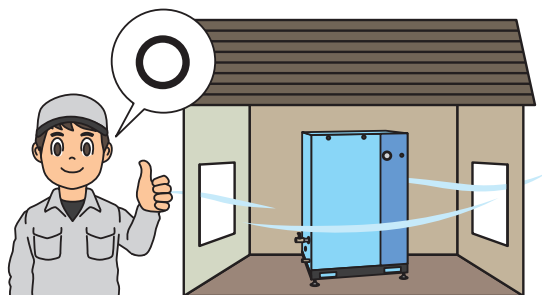

Install in a place with good ventilation

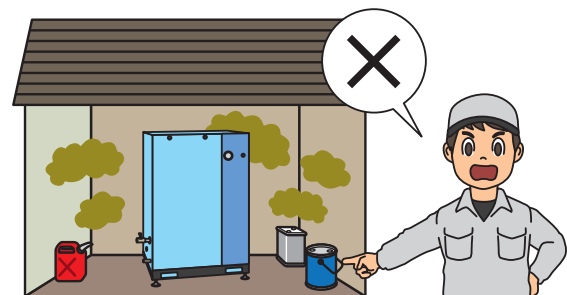

Keep away from fire

Car Washer

Use correctly

Hold the washing gun properly.

Caution!



Caution! Hot!



Beware of short circuiting or electrocution.

Tyre Changer

Check your surroundings before operating

Caution!

Make sure you don't trap your hands.

Use a safety guard

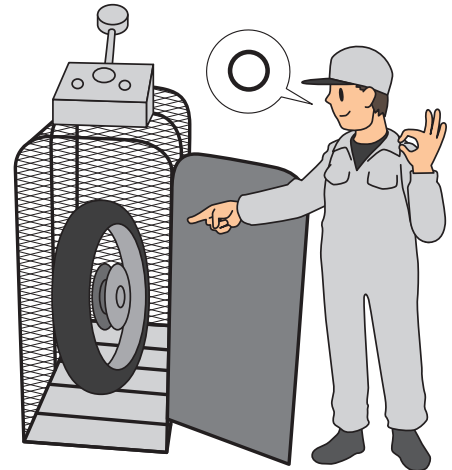

Wheel Balancer

Be careful of spinning tyres

Make sure your sleeves or other clothing parts do not get caught in the wheels.

Caution!

Make sure that no weights or pebbles fly out.

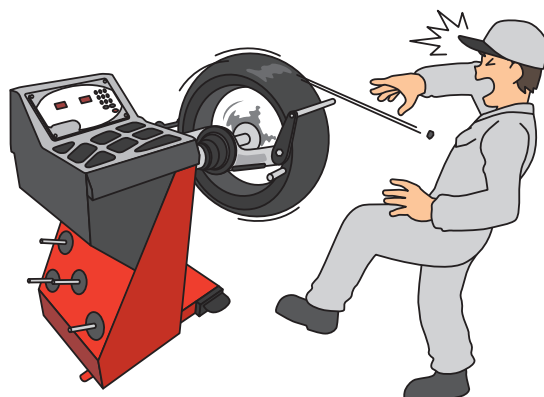

Remote Control Cable / Air Hose Reel

**Do not use if switches or air hoses
are scratched or damaged**

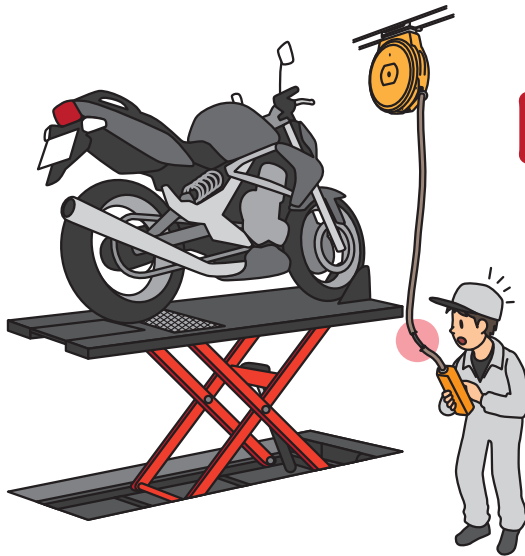

Don't!

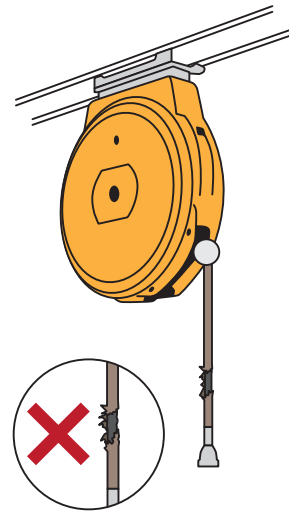

Extreme danger of possible short-circuiting or sudden lift movement and other malfunctions.

Very dangerous as chuck can fly off if the hose breaks.

**Do not touch the switch
with wet hands**

**Do not pull
cords too hard**



Don't!



There is a risk of electrocution.

This can damage cords and cause them to break with the possibility of malfunction.